

SENSORY MAP

This Sensory Map is designed to help those on the autism spectrum prepare for your visit to the Museum.

It covers sound, light and touch.

For more resources such as a Social Story of the Museum, visit:

merl.reading.ac.uk/visit-us/facilities-access

LIGHTING

The Museum is mostly well-lit, but the galleries are sometimes less well lit in order to reduce light damage on our objects. There are no sudden changes of artificial light, and the lighting in each gallery remains constant.

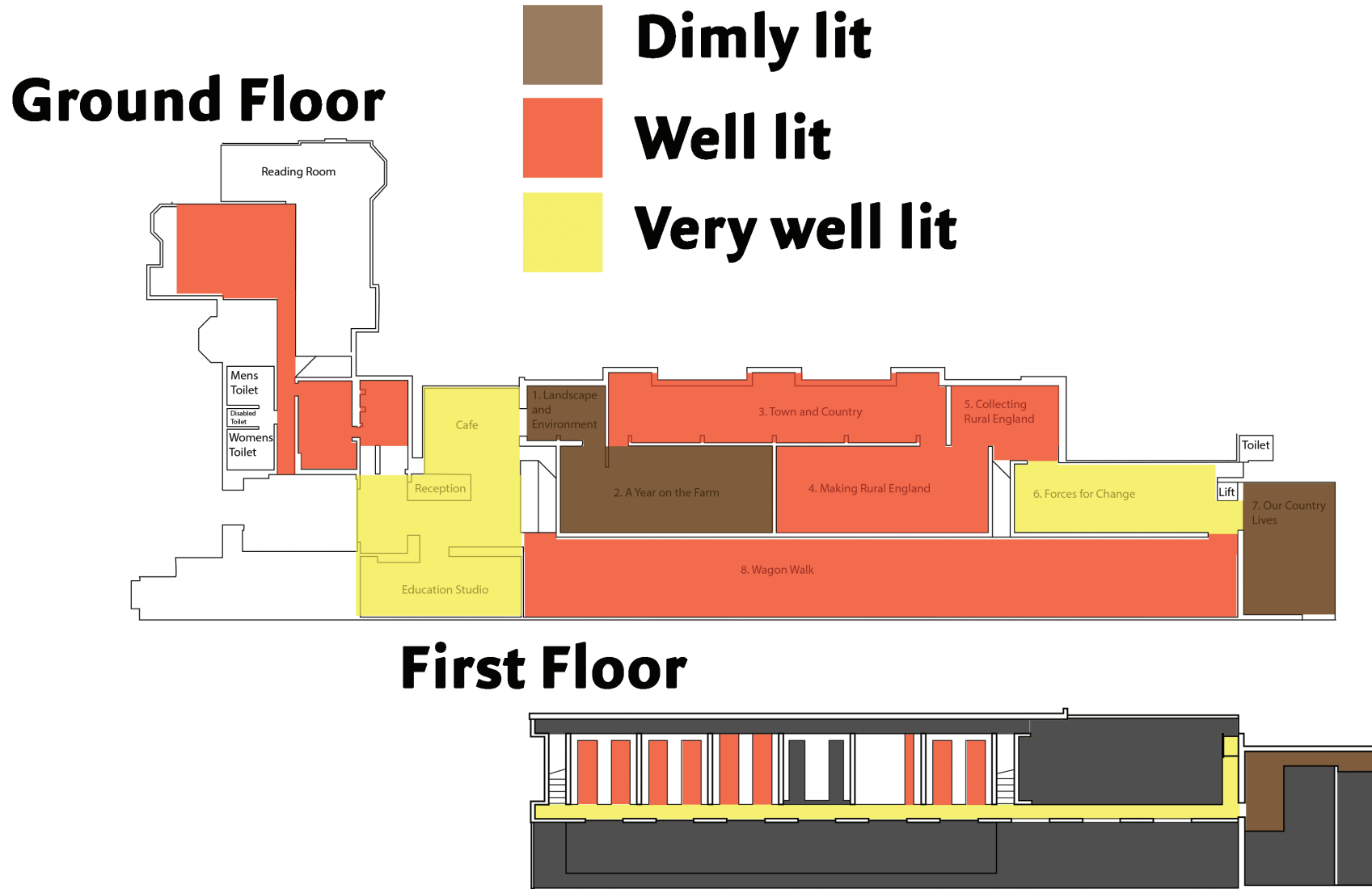

SOUND

The Museum is generally quiet, but there are speakers dotted around the galleries which emit constant background noises.

In Gallery 1: Landscape and Environment, there is an animation which shows the passing of the seasons and which includes a loud sound of thunder every few minutes. In the Wagon Walk there is a constant sound of blacksmithing and carriage noises, which you can also hear in galleries 2, 4 and 6.

The radio in Gallery 5 sometimes plays a sound of a person crying.

Ground Floor

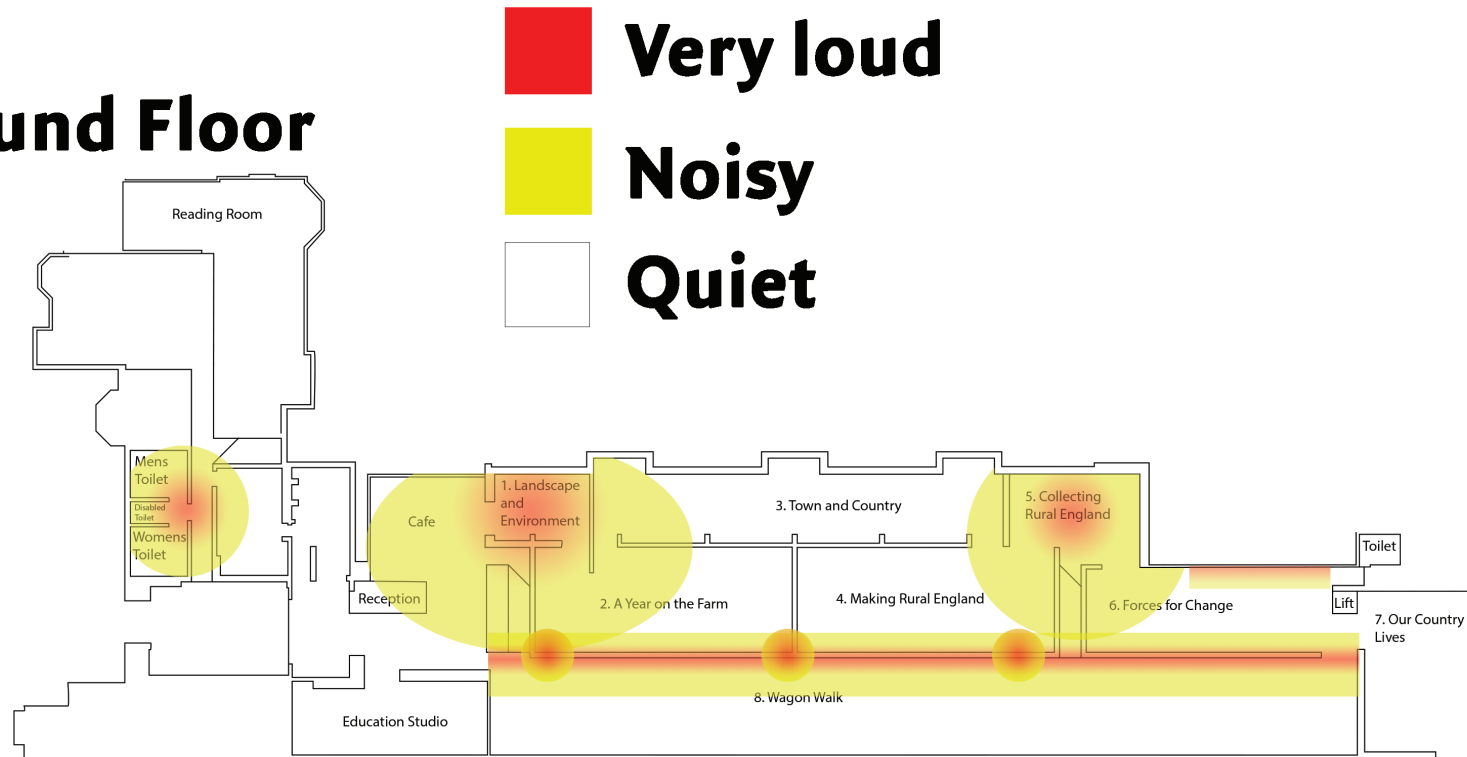

First Floor

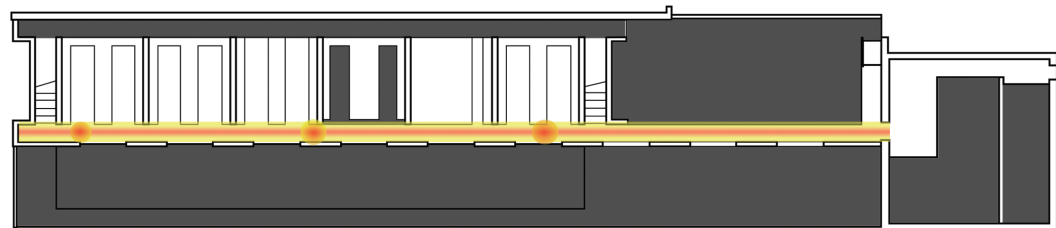

TOUCH

The Museum is quite interactive, but there are only a few things which visitors are allowed to touch. We do not currently have signs telling you what can and cannot be touched, but the non-digital interactives and digital interactives are shown below. These include things such as our sheep in Gallery 2 and various touch-screen interactives.

There are also mannequins dotted around our galleries, which cannot be touched.

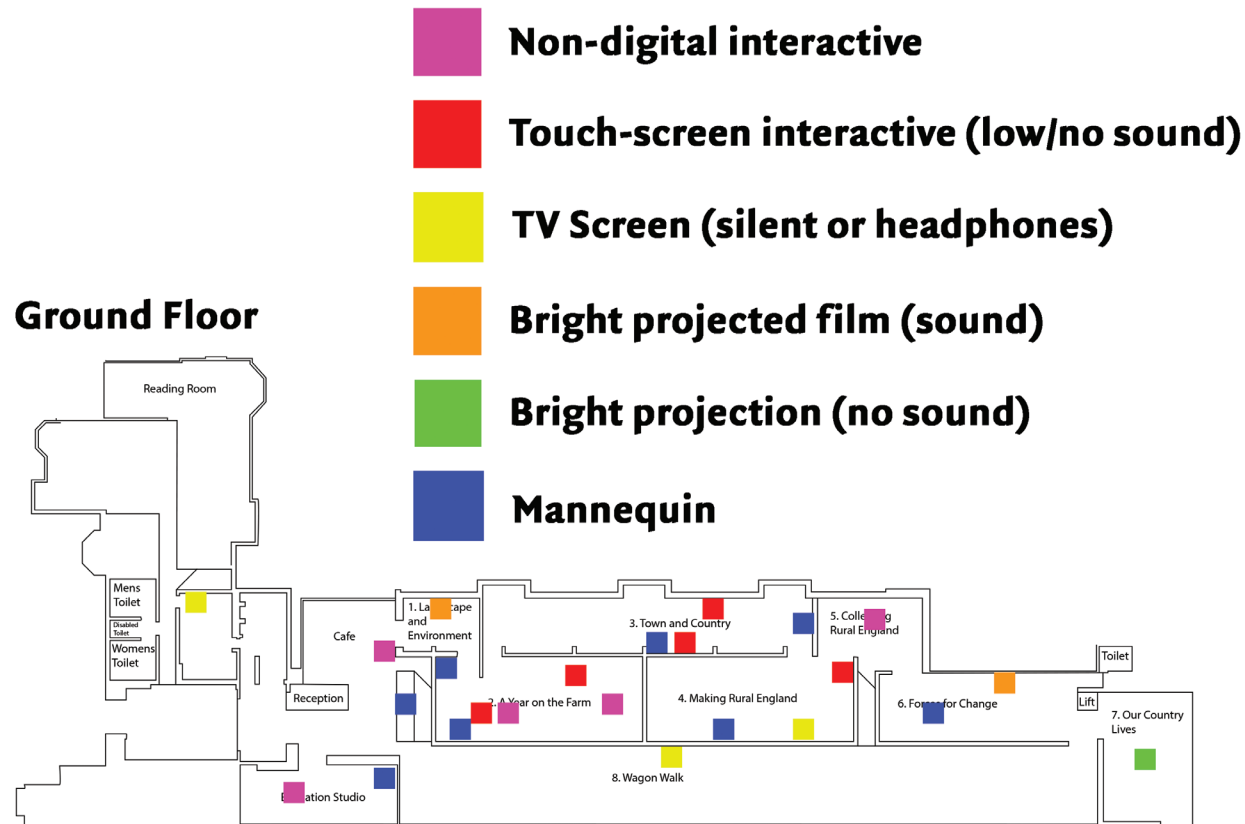

First Floor

